

SCHOOL SECTION NO. 8

DOMVILLE

LOT 5 - CONCESSION 4

TOWNSHIP OF AUGUSTA

Inspected: September 29, 1955.

By: M. Weeks & G. Dowker

Built
1876.

General Construction

Exterior: One storey stone building with stone entrance porch. The gable ends of the wall are of frame. The roof of the school is of wood shingle, while the porch has a metal clad roof. Brick chimney forms part of the building wall, not rodded.

Interior: Hardwood floor, plywood wainscoating and tentest walls and tentest ceiling. One blackboard.

Frame metal clad roof addition is used for wood and general storage.

Heating

One wood burning stove, set on metal base, exposed to classroom.

Water Supply

Water is obtained for fire protection from farm house $\frac{1}{4}$ mile distant.

Exposures

None.

Lighting

Hydro with lomex and conduit cabling.

Attendance

At present time, 26 children.

Recommendations

The stove exhaust piping is loose in several places and drops towards the chimney to the extent of about six inches, thus allowing for dirt and dust to accumulate within the pipe. It is recommended that this piping be taken down and cleaned and securely replaced in such a way that it will form a gradual rise from the stove to chimney.

The brick chimney itself is in very poor condition as can be seen in the two photographs opposite. It appears to be broken in several places, and is gradually falling away. It should be repaired at the soonest possible time.

Valuation

School

Replacement Cost New	\$16,534
Actual Cash Value	\$12,894

Outhouse

Replacement Cost New	\$ 560
Actual Cash Value	\$ 448

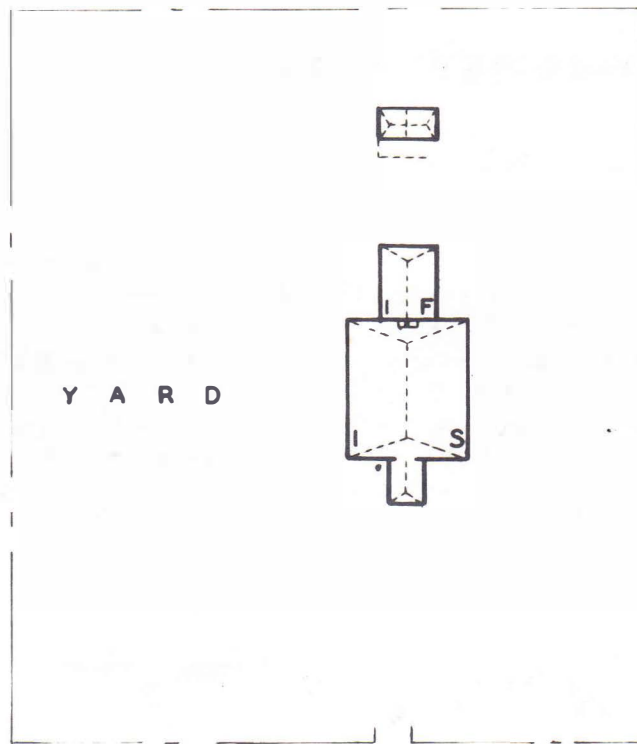

5TH CONCESSION ROAD



R O A D

Lomville

SCHOOL SECTION No 8

LOT 5 CONCESSION 4



S.S.# 8 1876
Domville

In the early days, up until 1875, the school was situated about 80 rods south of the present building, across the road from George Baker's farm. It was a small room, only about 20' square, built of stone. The pupils sat on benches and worked under difficulties, as usual in that time. A little to the north of the school, on the opposite side of the road, stood a little brick church. One of the early teachers was Mr. Clapperton, who later became Supt. of Education for the District. The walls of the school began to crumble, and it was condemned for use.

Mr. Carruthers, who owned the land on that side of the road, then donated the area where the school now stands. In 1875 it was built, with a woodshed at the northeast corner. About 40 years later, it was moved to the back of the schoolhouse. The outhouses were in the corners of the lot, and later moved back of the shed.

Miss Elizabeth Mealey, mother of Mrs. George Baker, taught in the old school, and was the first teacher in the new one. Mrs. Baker's daughter, Bernice Baker Brown, was to teach in this same building, years later.

Early in the 1920's, more land was purchased to enlarge the playground. In 1938, a new steel fence was erected across the east side, the front of the school. Trustees when the school was built were J. Carruthers, James Baker and Henry Bass. In 1938, Ray Eward, John Swan and Harry O'Hagan were on the Board. Others who served in the 1920's were Herb Bass, W. J. Barton, George Baker, Andrew Kelso and George Spero.

Two local girls each taught in the school for a large number of years. Mrs. Wm. Brown (Bernice Baker) and Mrs. Stewart Steed (Reita Kelso). Reita came directly from Normal School in 1919, salary \$700. By Inspector's orders, this was raised to \$800. She remained for 5 years that time, and later returned. When she retired in 1964, having been there for 3 years that time, her salary was \$3800. Trustees at the time she was first hired were John Gladstone, Herb Bass, James Barton George Spero and Andrew Kelso (her father).

The building was re-opened for a time, housing the overflow from Maynard Public School. 1967-68 - Mrs. May Gailey was there with a Special Education class . and again in 1968-69. When finally closed, it was boarded up, and thus it remains. For a brief time, it was used by the Domville Educational and Recreational Association for meetings.

*Lot and building property of Mrs. Mrs.
Milburn McCully.*

*Sold and being renovated for
residence 1990*