

1915.

General Construction
Exterior: One story frame building with frame entrance porch on stone foundations. Both have metal clad roofs. Brick chimney is of the brick type.
Interior: Hardwood floor, frame wainscoting and metal veneer walls and a metal veneer ceiling. One blackboard; one sink.
Separate frame metal storage of wood.

SCHOOL SECTION NO. 21

GARRETTON

One wood burning stove, set in metal base, exposed to classroom.

LOT 10 - CONCESSION 9

Water Supply
Water is obtained for fire protection from well located in school yard.

Exterior
None.

TOWNSHIP OF AUGUSTA

Interior
Hydro with B. I. and latex ceiling.

Attendance
At present time, 21 children.

Recommendation
See General Comments and Recommendations at beginning of report.

Valuation

School

\$13,430	Replacement Cost New
\$11,270	Actual Cash Value

Wood Shed

Inspected: September 27, 1955. By: M. Weeks & G. Dowker

Built
1915.

General Construction

Exterior: One storey frame building with frame entrance porch on stone foundations. Both have metal clad roofs. Brick chimney is of the bracket type.

Interior: Hardwood floor, frame wainscoating and metal veneer walls and a metal veneer ceiling. One blackboard; one sink.

Separate frame metal clad roof shed used for storage of wood.

Heating

One wood burning stove, set on metal base, exposed to classroom.

Water Supply

Water is obtained for fire protection from well located in school yard.

Exposures

None.

Lighting

Hydro with B. X. and lomex cabling.

Attendance

At present time, 21 children.

Recommendation

See General Comments and Recommendations at beginning of report.

Valuation

School

Replacement Cost New	\$13,420
Actual Cash Value	\$11,270

Wood Shed

Replacement Cost New	\$ 780
Actual Cash Value	\$ 640

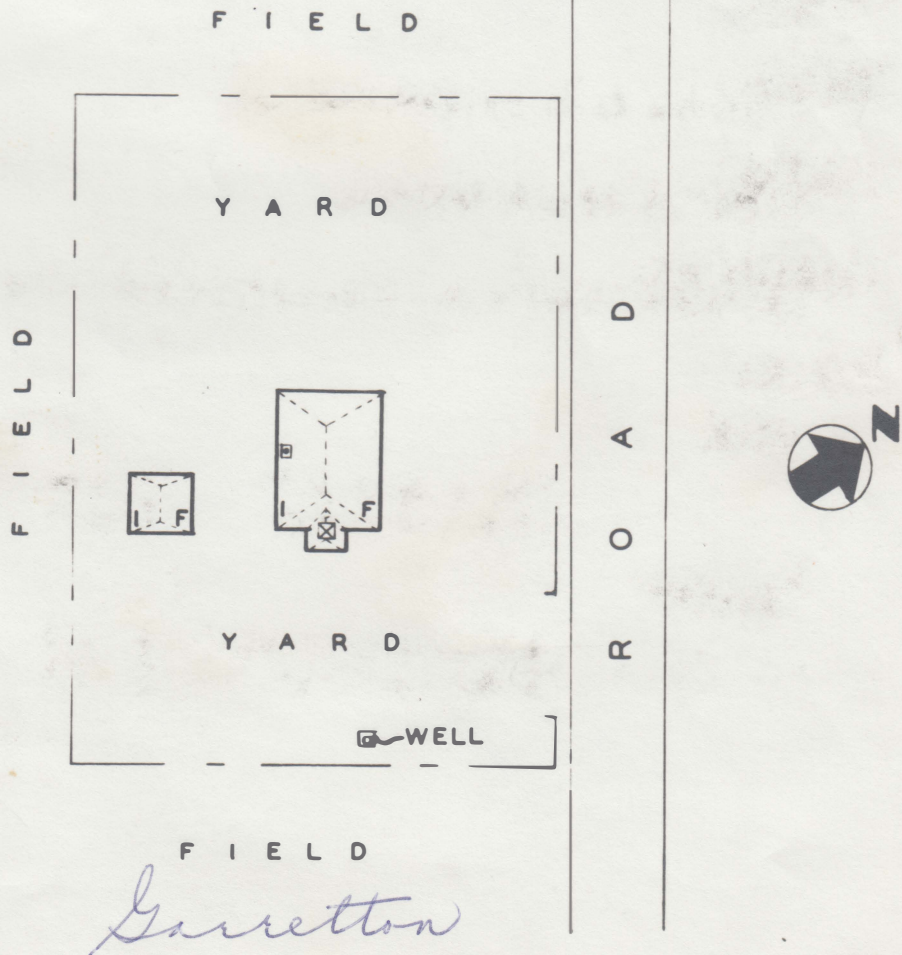

Garretton

SCHOOL SECTION No 21

LOT 10 CONCESSION 9

The following were teachers from 1878 to 1936:

Miss Jane Davis (Mrs. John McElree) 1878

Miss Elizabeth McElree 1879

Miss Jennie Thompson (Mrs. George Reynolds) 1879-80

Miss Lizzie Thompson, 1881-84

Mr. Wm. Harris, 1885

Miss Rosy and Mr. Ben Fletcher, 1886

Mr. Ben Maud, 1887-8

Mr. Archie Bellamy, 1889-90

Mr. Fred Fancit, 1891-92

Mr. Davie Clark, 1893-95

Miss Minnie McLellan (Mrs. Heman Throop) 1896

Mr. Baker, 1897-99

Miss Bertha McElree (Mrs. Robert Ferguson) 1900-04

Miss Bishop, 1905

Miss Sadie Lee, 1906

Mrs. Harvey A Smail, 1907

Mr. Eldon Percival, 1908

Miss Mary McNeill (Mrs. Bert Ferguson) 1909-10

Miss Annie Pickens, (Mrs. Velton McMullen), 1911-13

Miss Blanche Mundel (Mrs. Hught Kelso) 1914

Miss Agnes Coulthart (Mrs. Charlie Bush) 1915

Miss Sarah W. Smith (Mrs. Nat Streight) 1915

Miss Rheta Dool (Mrs. Fred Perkins) 1916

Miss Nellie White, 1917

Miss Davis, 1918

Miss Edna Flood (Mrs. Sam Stacey) 1918

Miss Gertie Jones, 1920-21

Miss Josie Summers (Mrs. Wm. Kinch) 1921-23

Miss Laura Coulthart, 1923

Miss Helen Mate, 1925

Miss Laura Dudley, 1925

Miss B. Bushfield, 1926

Miss C, M Sheldon , June 1926

Miss Gracie Robinson (Mrs. Dave Brooks)

Miss Marjorie Fairbairn (Mrs. Willis Drummond) 1927

Miss Marguerite Ferguson (Mrs. (Mrs. A. M. Barr) 1927-31

Miss Doris Gilhully 1931-32

Mr. Harold Henry, 1933-36

Miss Laura Walker, 1936-37

On May 11, 1937, two Coronation trees were planted, an oak and a maple.

--m Laura Walker, 1937

Miss A. E. Armstrong taught here from Sept. 1937 to June 1940

Miss C. Dodd of Timmins was here from Sept. 1940-June 1941

Mrs. Wm Reynolds of Algonquin then followed remaining during the Autumn term in 1941.

Mrs. Harry Ackland, succeeded Mrs. REynolds in January 1942.

Mrs. Josie Kinch followed in Setp. 1942- Feb. 1944

Miss Elinor Cross, March 20, 1944 - June 29, 1944

Mr. Alex Coleman, Sept. 1944 - June 27, 1947

Mrs. Harry Ackland, Sept. 1947 - June 1948

Miss Olive Liezert, Sept, 1948- June 1949

Miss Kathryn Hutton , Roebuck, Sept. 1949 - June 1950

Kenneth L. Sunderland, North Augusta, Sept. 1950- June 1951

Mrs. Josie Kinch, North Augusta, Sept. 1951-June 52 and on to 1958

Miss Marjorie McKinnon, 1958-1960

Sterling Murphy, Cardinal, 1960-61

Mrs. Doreen Sunderland, 1961-64

Ronald Gardiner, Principal 1964-65 with Mrs. Margaret Polite,
in Junior Room

Mrs. Margaret Polite, principal, 1965-67

Miss Gail Snider, Jr. Teacher, 1 year, then Kindergarten to 1969

Mrs. Rita (Marguerite) Morrell

Mrs. Laura Hall, last teacher, when school was closed and children
bussed to Maynard Public School.

GARRETTON SCHOOL

-copied from the register

The history of the school in our section is rather an interesting one. There were three schools, but many teachers.

Before any school was built, a teacher was hired who went from one home to another to board. The children gathered at the home where the teacher stayed. Even in the first school, attendance was poor. The big boys helped at home in the Spring, Summer and Fall, and attended school during the Winter. I heard one man say, "Those were the good old days."

The first school built in the section was a log one, built at the corner just south of the present one on the east side of the road. A few of the residents tell of the long benches and desks. One man told of having been pushed all the way along under the desk without the teacher having known what was taking place. At times, the water in the creek rose to such a height that they could row to the school door in a boat. In 1878, Miss Jane Davis taught in this school. She was followed in 1879 by Miss Elizabeth McElree, who was succeeded in 1880 by Miss Jennie Thompson. Miss Thompson received a salary of \$120 per year. In 1880, Mr. William Kinch was paid \$2 for lighting the fires.

A new school was built on the site of the present one. It went by the name of the "old red school". The woodshed was at the front and you had to pass through it to get into the school. In the course of time, this school got into poor condition. There were big rat holes in the floor, and many a poor teacher was terrified by the rats which appeared in these holes. The school was condemned. While the present one was being built, school was held in the old store which used to be opposite the old log school on the west side of the road.

The present school was built in 1915. The cost of the site was \$500.00, and the school itself cost \$2,200. It was a great improvement on the old school.

There have been many students enter and leave the school. Most of them have become good Canadian citizens. The school, however, has not been without its famous men. Mr. Sam Johnston, who attended the old log school, became a senator in the State of Minnesota, USA. Mr. Sam Streight, who went to the old red school, is now a doctor in Toronto.